

AXENT.ONE

**USER** MANUAL

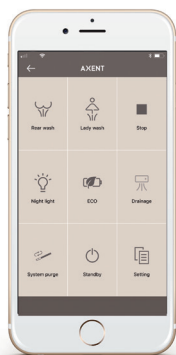



### **CONNECT YOUR AXENT SHOWER TOILET WITH OUR APP**

---

Like a remote control, you can regulate the flow rate, spray arm position and temperature of various applications individually according to your needs.

### **STEUERN SIE IHR AXENT DUSCH-WC MIT UNSERER APP**

---

Wie bei einer Fernbedienung lassen sich die Duschstrahl-Stärke, Position und Temperatur der verschiedenen Anwendungen individuell einstellen.

### **CONNECTEZ VOTRE WC LAVANT AXENT À NOTRE APPLICATION**

---

Comme avec la télécommande, vous pouvez ajuster l'intensité du jet d'eau, la position de la douchette et la température des diverses applications en fonction de vos besoins.

### **LINK UW DOUCHEWC VAN AXENT MET ONZE APP**

---

Net als bij een afstandsbediening kunt u het watervolume, de stand van de sproeiarm en de temperatuur van diverse toepassingen individueel regelen volgens uw behoeften.

### **TILSLUT DIT AXENT BRUSEBAD TOILET MED VORES APP**

---

Som en fjernbetjening kan du regulere strømningshastigheder, sprayarmens position og temperaturen på forskellige applikationer individuelt efter dine behov.

[www.axent-bclean.com](http://www.axent-bclean.com) » Downloads

## **ENGLISH**

---

We appreciate your choice of a product from AXENT. To fully benefit from the options offered by this product please read this User Guide before use and save it for future reference.

**USER MANUAL**

---

**AXENT.ONE AND AXENT.ONE<sup>PLUS</sup>**

Safety	4
Operation	6
Additional features	8
Use with remote control	14
Maintenance	20
Malfunctions during operation	23
Guarantee / Environment	25
Technical data	26

# SAFETY

## APPROPRIATE USE

---

The AXENT shower toilet is designed for anal and genital cleansing. Not included are other purposes deemed improper.

AXENT does not accept liability for the consequences of improper use or installation.

## OPERATION

---

The AXENT shower toilet can be used by children aged from 8 years and above and persons with reduced physical, sensory or mental capabilities or lack of experience and knowledge if they have been given supervision or instruction concerning use of the AXENT shower toilet in a safe way and understand the hazards

involved. Children shall not play with the appliance. Cleaning and user maintenance shall not be made by children without supervision. Each person perceives temperatures individually; therefore check the water, air dryer and seat temperature before use.



## SAFETY INSTRUCTION

---

Do not take a damaged device or main connection cables into operation. Connect the device only to an earthed electrical voltage as specified on the type label. For further information please refer to the technical data sheet.

may only be carried out by authorised and trained persons using original spare parts and accessories. Only standard accessories, original spare parts and the delivery included main connection cable may be used.

The original hose-sets supplied with the appliance shall be used. The old hose-sets should not be re-used.

Do not make any modification on the main connection cable. Should it be damaged, it must be replaced by AXENT customer service.

The normal shower toilet should be checked on regular bases. Should there be a suspicion of defect on the device detach the shower toilet immediately of the power grid and contact the customer service of AXENT.

In case of malfunction during operating consult the basic information at the point Troubleshooting. If required contact customer service.

Do not open and repair the unit yourself or install it. Never modify the device or add any additional modules.

Operation and maintenance work may only be performed by the operator or user as described in these operating instructions. For the use of AXENT shower toilet only drinking water may be used no rain nor grey water

The AXENT shower toilet carries live parts and opening it exposes those present to fatal danger!

Repairs done by not skilled or authorised persons can lead to malfunction, damage and dangerous accidents. Therefore repairs



For care and cleaning of the device only use the care and cleaning products recommended by AXENT. Should other not recommended cleaning products be used AXENT will assume no liability.

This user manual corresponds to the state of the device technology at the time of printing. AXENT reserves the right to make changes in terms of further development. This documentation is also subject to change. A current version of this document and additional documents can be downloaded via [www.axent-bclean.com](http://www.axent-bclean.com).

# SAFETY



## TOILET SEAT AND LID WITH LOWERING FUNCTION

---

Dampers cushion the toilet seat and lid noiselessly and slow down closing. The seat and lid open just like any normal toilet seat and lid.



Do not press the toilet seat and lid down with your hand. This will damage the dampers.

The maximum loading capacity of seat and lid is 150 kg.

**PLEASE KEEP THIS USER MANUAL SAFE**

## LEGAL DIRECTIONS

---

This manual contains important information on the intended use, correct operation and proper maintenance of the equipment. Knowledge of and compliance with the instructions of this manual are provided for both the safe use of the equipment and for the safety of its operation and maintenance. In this manual, not all kinds of applications and improper manipulations are considered. In addition, attention is drawn to the following: The content of these instructions is neither part of any previous or existing agreement, commitment or legal relationship, nor does it change from an existing agreement, commitment or legal relationship. Any commitment by AXENT results from the respective warranty. These include the complete and authoritative warranty obligation AXENT. The statements in this manual do not constitute an extension or a restriction of the claims under the warranty provisions. This manual is protected by copyright. Copies and / or translations into other languages may be made only with prior written approval of AXENT.

# OPERATION

## QUICK START

---

AXENT.ONE offers a Quick Start function. Sit down on the toilet seat and push the button.

The shower starts and will stop after another push on the button



The spray nozzle is automatically cleaned with water before and after each shower procedure.

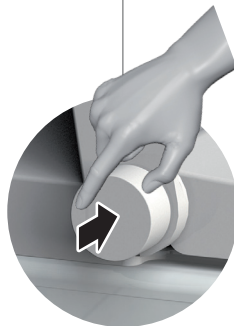

Rear Wash



Stop



# OPERATION

## REGULAR USE

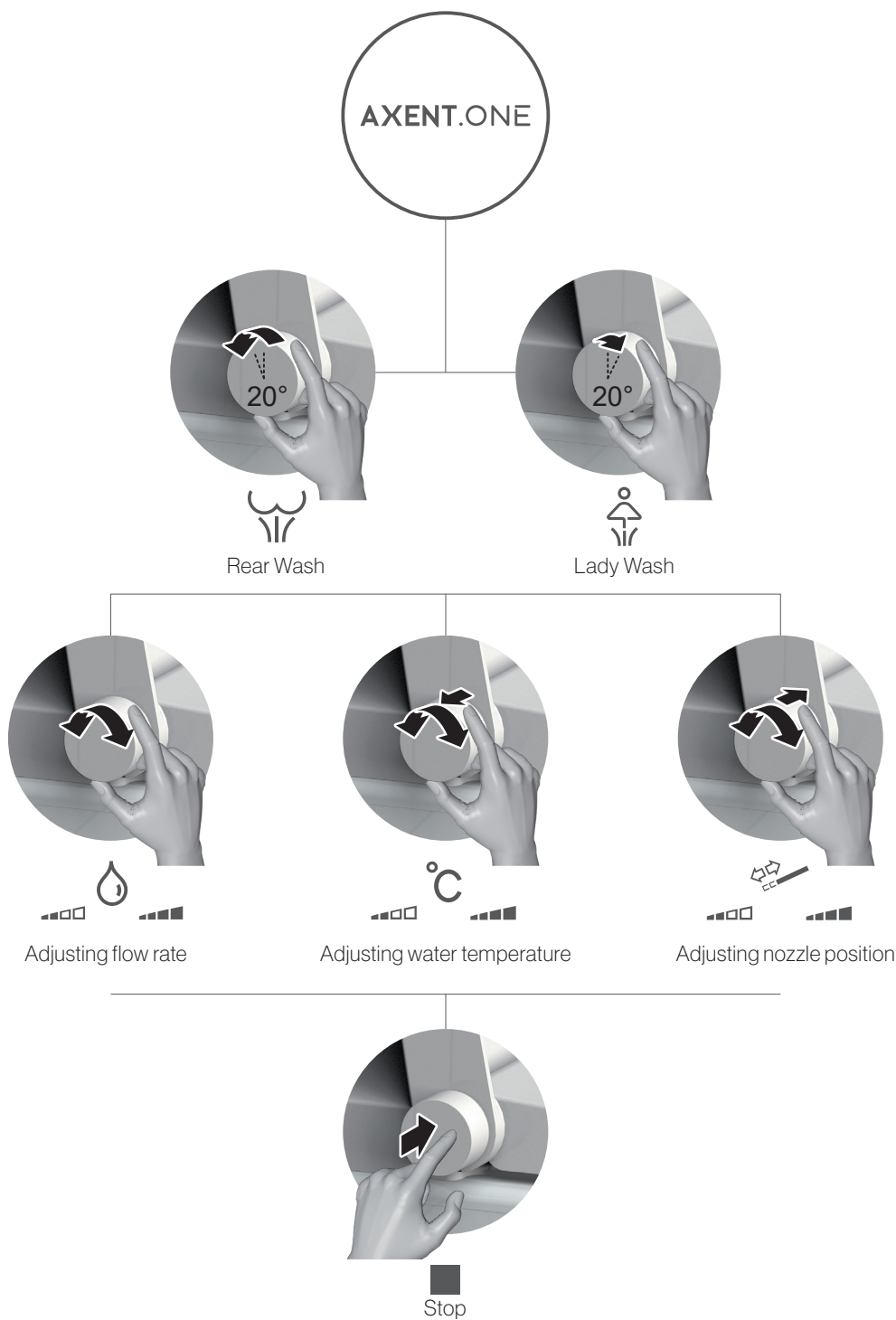

# OPERATION

## STAND-BY MODUS

---



### ACTIVATE FUNCTION

---

To activate the STAND-BY MODE, press and hold down the multi-function button until the «Ambient light» flashes slowly, then goes out.

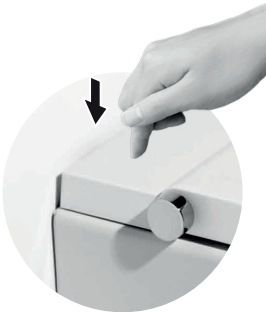

### DEACTIVATE FUNCTION

---

The STAND-BY MODE is deactivated by tapping the rear cover gently (left, above the control knob).

# ADDITIONAL FEATURES

With the multifunction knob, beside the primary functions, additional settings can be changed or service functions made on two main levels.

## LEVEL 1

- Signal ton
- Seat heating for AXENT.ONE<sup>Plus</sup> only
- Automatic self-cleaning function for AXENT.ONE<sup>Plus</sup> only
- System purge
- Emptying the water tank



## ACTIVATE FUNCTIONS AT LEVEL 1

---

To activate mode level 1, hold the multifunction knob until the «Ambient light» flashes slowly. The «Ambient light» continues to flash.



For AXTENT.ONE only:  
Please place the splash guard on the toilet



## DEACTIVATE FUNCTIONS AT LEVEL 1

---

You are in the mode level 1: Push the multifunction knob.  
The «Ambient light» stops flashing and you hear one time «beep».  
The mode level 1 is deactivated.



If no operations are done within 3 minutes, the mode level 1 will be deactivated automatically.

# ADDITIONAL FEATURES



## LEVEL 1 SIGNAL TON

---

Factory setting: The signal tone is activated.

You are in the mode level 1: The «Ambient light» flashes slowly.  
Turn the multifunction knob anticlockwise.

Single «beep» The signal tone is deactivated.

Two «beeps» The signal tone is activated

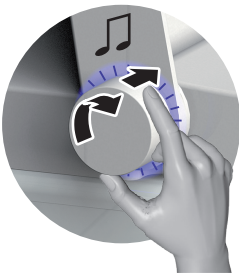

## LEVEL 1 SEAT HEATING

---

For AXENT.ONE<sup>Plus</sup> only.

Factory setting: The seat heating is activated.

You are in the mode level 1: The «Ambient light» flashes slowly.

- Hold down the multifunction knob.
- Turn clockwise.

Single «beep» The seat heating is activated. The temperature of the seat heating can be adjusted using the remote control.

Two «beeps» The seat heating works the same way as «energy saving mode» on page 19.

Three «beeps» The seat heating is deactivated

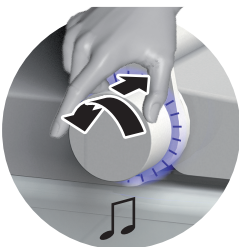

## LEVEL 1 AUTOMATIC SELF-CLEANING

---

For AXENT.ONE Plus only.

As soon as you sit down on the shower toilet, the spray arm is automatically cleaned with fresh water. This function can be activated and deactivated.

Factory setting: Automatic self-cleaning function is activated.

You are in the mode level 1: The «Ambient light» flashes slowly.

- Hold down the multifunction knob.
- Turn it anticlockwise.

Single «beep» Automatic self-cleaning function is activated.

Two «beeps» Automatic self-cleaning function is deactivated.

# ADDITIONAL FEATURES



## LEVEL 1      SYSTEM PURGE

---

After a long time of not using the shower toilet, all water bearing parts can be exchanged with fresh water.

You are in the mode level 1: «Ambient light» flashes slowly.

- Turn multifunction knob clockwise.
- You will hear one «beep». The system purge has started.

The system purge process stops after 90s automatically.



Turn multifunction knob clockwise again to stop the system purge procedure immediately.

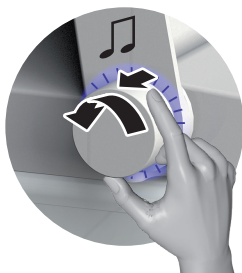

## LEVEL 1      EMPTYING THE WATER TANK

---

In case of a service intervention, you might be obliged to empty the water tank.

You are in the mode level 1: «Ambient light» flashes slowly.

- Pull the multifunction knob.
- Turn it counter clockwise.

The pump empties the water tank. You will hear a «beep» if the process is finished.

# ADDITIONAL FEATURES

With the multifunction knob, beside the primary functions, additional settings can be changed or service functions made on two main levels.

## LEVEL 2

- Night light
- Automatic deodorizer for AXENT.ONE<sup>Plus</sup> only
- Decalcification for water-bearing parts
- Spray arm cleaning
- System reset



## ACTIVATE FUNCTIONS AT LEVEL 2

---

By pressing the multifunction knob for 5 seconds until the «Ambient light» flashes slowly, the mode level 1 is activated.

To activate mode level 2, hold the multifunction knob until the «Ambient light» flashes quickly



## DEACTIVATE FUNCTIONS AT LEVEL 2

---

You are in the mode level 2. Push the multifunction knob.

The «Ambient light» stops flashing and you hear one time «beep».

The mode level 2 is deactivated.



If no operations are done within 3 minutes, the mode level 2 will be deactivated automatically.

# ADDITIONAL FEATURES



## LEVEL 2 NIGHT LIGHT

---

Factory setting:

The night light will automatically switch on or off depending on ambient brightness.

You are in the mode level 2: The «Ambient light» flashes quickly.  
Turn the multifunction knob anticlockwise.

Single «beep»

The night light is permanently switched on.

Two «beeps»

The night light will automatically switch on or off depending on ambient brightness.

Three «beeps»

The night light is permanently switched off.

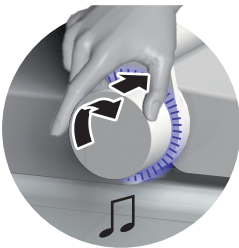

## LEVEL 2 AUTOMATIC DEODORIZER

---

For AXENT.ONE<sup>Plus</sup> only.

As soon as you sit down on the shower toilet, the deodorizer starts automatically.  
This function can be activated and deactivated.

Factory setting:

Automatic deodorizer is activated.

You are in the mode level 2: The «Ambient light» flashes quickly.

- Hold down the multifunction knob.
- Turn clockwise.

Single «beep»

Automatic deodorizer is activated.

Two «beeps»

Automatic deodorizer is deactivated.

## ADDITIONAL FEATURES

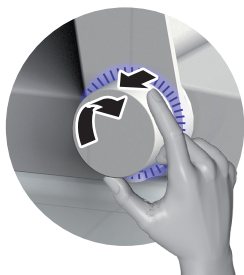

### LEVEL 2

### DECALCIFICATION FOR THE WATER-BEARING PARTS

---

The entire water system can easily be decalcified like a coffee machine. Fill a cup with 200ml decalcification liquid (Durgol preferred).

You are in the mode level 2: «Ambient light» flashes quickly

- Pull the multifunction knob.
- Turn it clockwise.



The water system will be drained completely and the spray arm is moving out without any water spray function.

- Hold the cup close the spray arm.
- Dip the spray arm into the cup with the decalcification liquid.

The liquid will be absorbed. The spray arm moves back into its position.

The decalcification liquid will circulate in the water-bearing parts in order to dissolve the limestone.

The decalcification liquid will be ejected automatically.

The whole water-bearing system will be rinsed 3 times with fresh water.

This process takes around 3 minutes and cannot be interrupted.

The night light flashes slowly during the entire process.



# ADDITIONAL FEATURES

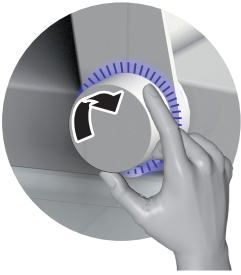

## LEVEL 2 SPRAY ARM CLEANING

---

You are in the mode level 2: «Ambient light» flashes quickly

- Turn the multifunction knob clockwise.

The spray arm will move out.

- Clean the spray arm with a fabric.
- Turn the multifunction knob clockwise again.

The spray arm will move back to its position.



If no operations are done within 3 minutes, the spray arm will move back automatically.



## LEVEL 2 SYSTEM RESET

---

You are in the mode level 2: «Ambient light» flashes quickly

- Pull the multifunction knob.
- Turn it counter clockwise.

Single «beep»

All values are reset to factory settings

If you turn the multifunction knob again, a 3 seconds «beep» will inform you that the system will be re-started.

# USE WITH REMOTE CONTROL



The remote control is part of the product content of AXENT.ONE<sup>Plus</sup> only.

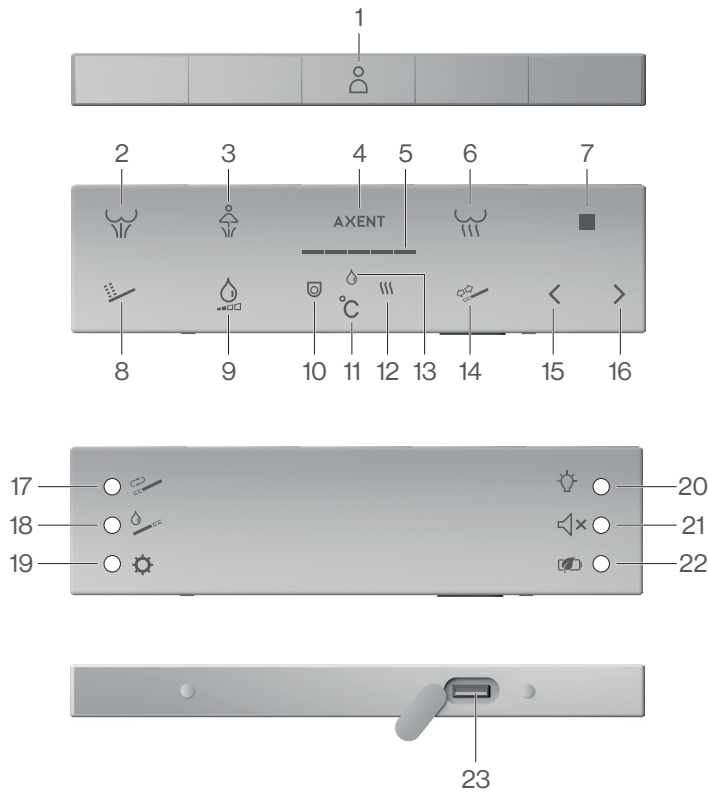

## REMOTE CONTROL ON/OFF/CHARGING

ON	The remote control is powered off initially. Press [ 19 ] Set for 2 sec. to turn on the remote control.
OFF	Press [ 19 ] Set and at the same time [ 1 ] User for 2 sec. to turn off the remote control.
Charging	When the power is less than 15%, the [ 4 ] AXENT Logo blinks on and off, which means the battery needs to be charged. Please connect the standard charge cable to the Charge port [ 23 ] on the remote control. The [ 5 ] Indicator Lights indicates the battery power and all 5 lights are on when remote control is fully charged.



Don't charge remote control in moist condition.

The rechargeable Li-ion battery is built into the remote control and can't be disassembled by users. Please contact the local dealer or call the service hot line if there is any problem.

## STAND-BY MODE REMOTE CONTROL

The remote control enters into the standby mode automatically and all indicator lights turn off when there is no activity for some time. Press any icon to exit the standby mode.

# USE WITH REMOTE CONTROL

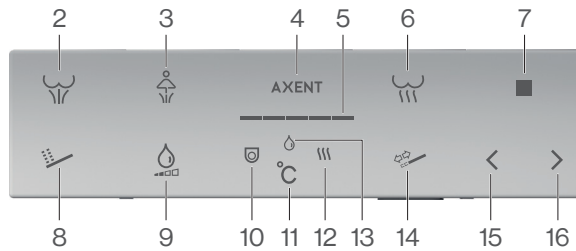

## REAR WASH

Press [ 2 ] Rear wash after you are seated; the [ 2 ] Rear wash icon starts to blink and starts the function.

The [ 2 ] Rear wash icon lights up and the shower process is started.

Press [ 7 ] Stop to stop the Rear wash.

The Rear wash will stop automatically after continuous usage of 3 minutes.

## LADY WASH

Press [ 3 ] Lady wash after you are seated; the [ 3 ] Lady wash icon starts to blink and starts the function.

The [ 3 ] Lady wash icon lights up and the shower process is started

Press [ 7 ] Stop to stop the Lady wash.

The Lady wash will stop automatically after continuous usage of 3 minutes.

## WATER TEMPERATURE

During the shower, repeatedly press [ 11 ] Temperature to select the [ 13 ] Water temperature. The water temperature can be reduced and increased using the buttons [ 15 ] and [ 16 ]. The [ 5 ] Indicator lights show 5 levels for the water temperature. If the indicator lights are off, the water temperature corresponds to the cold-water temperature.

## AIR DRYER

Press [ 6 ] Dryer after you are seated; [ 6 ] Dryer illuminates and starts the function.

Air dryer icon lights up and the air dryer function is started.

Press [ 7 ] Stop to finish the function.

The stops automatically after 3 minutes.

## AIR DRYER TEMPERATURE

During the drying process, repeatedly press [ 11 ] Temperature to select the [ 12 ] Air dryer temperature. The air dryer temperature can be reduced and increased using the buttons [ 15 ] and [ 16 ]. The [ 5 ] Indicator lights show 5 levels for the air dryer temperature. If the indicator lights are off, the air dryer temperature corresponds to the cold air temperature.

## SEAT TEMPERATURE

Repeatedly press [ 11 ] Temperature to select the [ 10 ] Seat temperature. The seat temperature can be reduced and increased using the buttons [ 15 ] and [ 16 ]. The [ 5 ] Indicator lights show 5 levels for the seat temperature. If the indicator lights are off, the seat heating is switched off.

# USE WITH REMOTE CONTROL

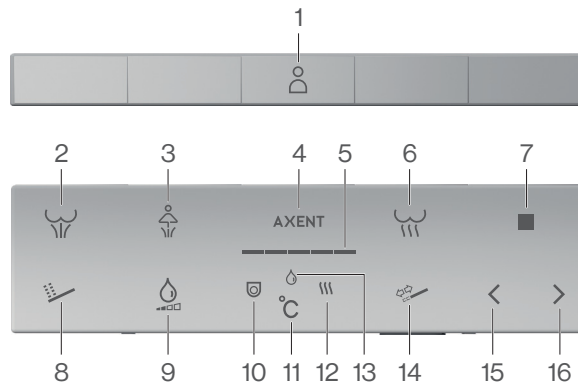

## SPRAY ARM POSITION

Press [ 14 ] Spray arm during the Rear or Lady wash. [ 14 ] Spray arm illuminates and the position can be regulated. Press [ 15 ] Minus to move the Spray arm back. Press [ 16 ] Plus to move the Spray arm forward. The [ 5 ] Indicator lights indicates the selected Spray arm position.

## WATER VOLUME

Press [ 9 ] Water volume during Rear or Lady wash, [ 9 ] Water volume illuminates and the water volume can be regulated. Press [ 15 ] Minus to reduce the water volume. Press [ 16 ] Plus to increase the water volume. The [ 5 ] Indicator lights indicates the selected water volume.

## OSCILLATING AND PULSATING SHOWER

Press [ 8 ] Massage to activate oscillating, pulsating, or oscillating and pulsating wash during the Rear and Lady wash.

Oscillating: Press [ 8 ] Massage

Pulsating: Press [ 8 ] Massage twice.

Pulsating and oscillating: Press [ 8 ] Massage three times

After pressing three times the [ 8 ] Massage function, the regular Rear or Lady wash is in place again.

## USER PROFILE

Up to 5 user profiles can be stored. Press [ 1 ] User profile repeatedly to select your profile. The [ 5 ] Indicator lights show the selected profile.

You are sitting on the shower toilet. Press [ 2 ] Rear wash or [ 3 ] Lady wash to start the shower process. You can set water temperature, flow rate and spray arm position during the shower procedure according to your personal needs. Press [ 7 ] Stop to end the shower process. The personal settings listed above are automatically stored in your profile.

For the next use, first select your profile and then start the shower procedure.



Only the water temperature, flow rate and spray arm position can be programmed for the rear wash and lady wash.

# USE WITH REMOTE CONTROL



## AUTOMATIC DEODORIZER

The deodorizer function is automatically activated when a user sits down on the shower toilet.

Press and hold [ 19 ] Setting and press [ 21 ] Signal tone to activate or deactivate the automatic deodorizer.

One «beep»	The automatic deodorizer is activated.
Two «beeps»	The automatic deodorizer is deactivated.
Factory setting:	Automatic deodorizer is activated.

## NIGHT LIGHT

Press [ 20 ] Night light to enter into the settings. Press [ 20 ] Night light repeatedly to switch among ON, OFF and AUTO.

Single «beep» The night light is permanently switched on.

Two «beeps»	The night light will automatically switch on or off depending on ambient brightness.
Three «beeps»	The night light is permanently switched off.
Factory setting:	The night light will automatically switch on or off depending on ambient brightness.

## SIGNAL TON

Press [ 21 ] Signal tone to activate or deactivate it.

Single «beep»	The signal tone is deactivated.
Two «beeps»	The signal tone is activated.
Factory setting:	The signal tone is activated

## ENERGY SAVING

The energy-saving mode refers to seat heating.

If the energy saving mode is enabled, the shower toilet remembers the uses. The uses are recorded on an hourly basis and saved as a profile. The seat heating is now switched on automatically according to the saved profile. The profile is updated every day.

Press [ 22 ] Energy-saving mode to activate or deactivate it.

Two «beeps»	The energy-saving mode is activated.
Three «beeps»	The energy-saving mode is deactivated.
Factory setting:	The energy-saving mode is deactivated.

# USE WITH REMOTE CONTROL

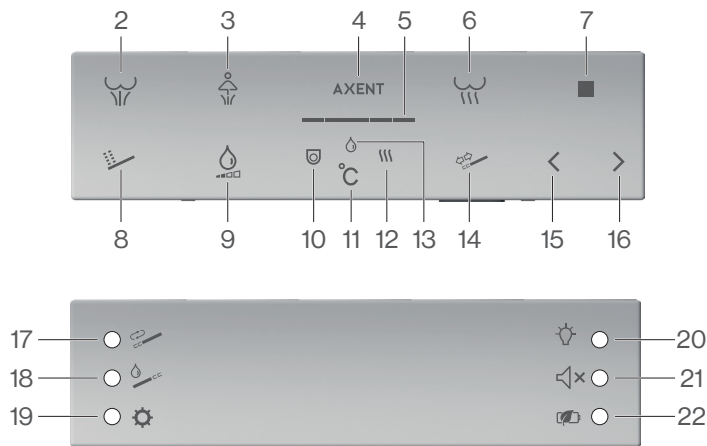

## SELF-CLEANING FUNCTION

As soon as you sit down on the shower toilet, the spray arm is cleaned with fresh water.  
This function can be activated or deactivated.

Press and hold [ 19 ] Setting and [ 22 ] Energy-saving mode in order to activate or deactivate the automatic self-cleaning function.

Single short «beep» and LED [ 22 ] Energy-saving mode lights up.  
Automatic self-cleaning function is activated.

Single long «beep» and LED [ 22 ] Energy-saving mode goes out.  
Automatic self-cleaning function is deactivated.

Factory setting: Automatic self-cleaning function is activated.

## SPRAY ARM CLEANING

Press [ 18 ] Spray arm cleaning. The spray arm extends without a water jet.  
Clean the spray arm with a soft cloth, sponge or brush.  
Press [ 18 ] Spray arm cleaning or [ 7 ] Stop. The spray arm will move back to its starting position.



If neither are pressed within 3 minutes, the spray arm will move back automatically

# USE WITH REMOTE CONTROL

## DECALCIFICATION OF THE WATER-BEARING PARTS

---

The entire water system can easily be decalcified like a coffee machine. Fill a cup with 200ml decalcification liquid (Durgol preferred).

Press and hold [ 19 ] Setting and press [ 18 ] Spray arm cleaning to start the process.

The water system will be drained completely and the spray arm is moving out without any water spray function.

- Hold the cup close the spray arm.
- Dip the spray arm into the cup with the decalcification liquid.

The liquid will be absorbed. The spray arm moves back into its position.

The decalcification liquid will circulate in the water-bearing parts in order to dissolve the limestone.

The decalcification liquid will be ejected automatically.

The whole water-bearing system will be rinsed 3 times with fresh water.

This process takes around 3 minutes and cannot be interrupted.



The night light flashes slowly during the entire process.

## SYSTEM PURGE

---

After a long time of not using the shower toilet, all water bearing parts can be flushed with fresh water.

Press [ 17 ] System purge to turn on the function.

The system purge process stops automatically after 90s.



Press [ 17 ] System purge again to immediately stop the system purge.

## EMPTY THE WATER TANK

---

In case of a service intervention, you might be obliged to empty the water tank.

To start the procedure, press and hold [ 19 ] Setting and press [ 17 ] System purge.

The pump empties the water tank. You will hear a «beep» if the process is finished.

## SYSTEM RESET

---

Switch off the remote control by pressing [ 19 ] Setting + [ 1 ] User simultaneously.

Press and hold the [22] Energy-saving mode and press [ 19 ] Setting.

The device sounds a long «beep».

The remote control is switched on. The device is restarted automatically.

All values are reset to factory settings.

# MAINTENANCE

This product has been designed and manufactured with great care and attention to detail. If you follow a few simple cleaning instructions you will be able to enjoy its comfort, quality and beauty every day.



## CLEANING INSTRUCTIONS SEAT, LID AND BACK COVER

Use a mild soap solution to clean the seat and please take care that the seat and hinges are not left damp. Dry off any residual water or cleaning agent with a soft cloth. Avoid contact of the seat and hinges with abrasive, corrosive or chlorine-based cleaners, as

these may cause damage or lead to flash rust. Therefore, when cleaning the bowl, make sure that the seat and cover are kept in an upright position until all cleaning agent has been flushed away.

## CLEANING INSTRUCTIONS CERAMIC

Under no circumstances should you use harsh or abrasive cleaning substances such as abrasive cream cleansers, scouring powder or drain cleaner on your ceramic surfaces. Also avoid using steam cleaners and hard, abrasive sponges. Please bear in mind that hair colouring products can reduce the effectiveness of AXENT Easy Clean.

If you follow this guidance then you should remain satisfied with the performance of AXENT Easy Clean for many years. Recommended cleaners for sanitary ceramic surfaces with AXENT Easy Clean finish. The use of acidic cleaners with a pH value between 1 and 4 is highly recommended. Cleaners with a pH value in the neutral range (5 to 8) are not always suitable. We strongly advise against using either weak or strong alkaline cleaners, i.e. substances with pH values from 9 to 12.

## CLEANING RECOMMENDATION

Cleaning interval	Cleaning extent
Daily	– Wipe water drops dry with a soft, lint-free cloth
Weekly	– Remove the toilet seat and lid and clean them separately – Thoroughly wipe all surfaces and corners with a damp, lint-free cloth and a mild, liquid cleaning agent – Check the spray nozzle for signs of scaling – To clean the toilet ceramic appliance, apply a mild, liquid bathroom cleaner (pH value 1–4) for 30 min. Then clean with a toilet brush and rinse with water.
Half-year	– Work out the decalcification program



For AXENT.ONE only  
TO CLEAN THE MULTIFUNCTION KNOB, PLEASE REMOVE THE SPLASH GUARD ON THE TOILET.



# MAINTENANCE



## REMOVING THE TOILET SEAT AND LID

---



The toilet seat and lid can be removed, cleaned and remounted quickly and easily when heavily soiled.

1. Lift up the toilet seat and toilet lid.
2. Remove the toilet seat and toilet lid by vertical lifting them out of the bracket.
3. Clean the toilet seat and toilet lid.
4. Insert the toilet seat and toilet lid vertically from the top into the bracket in the same way as removed.
5. Let the toilet seat and toilet lid glide down.



# MAINTENANCE

## CLEANING OR REPLACING THE BASKET FILTER



In the case of the floor-standing model, the basket filter must be replaced by a skilled person.

1. Disconnect the power plug.
2. Close the ball valve underneath the toilet ceramic appliance.

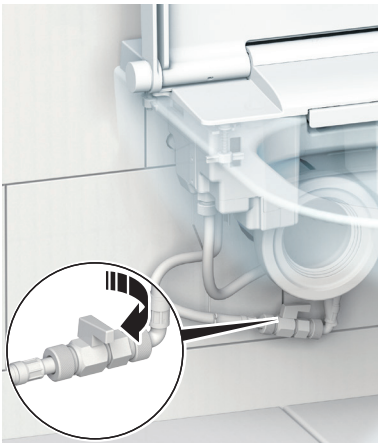

3. Remove the reinforced braided hose by hand and drain the residual water into a receptacle.

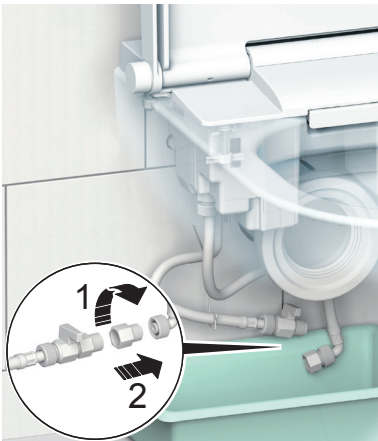

4. Remove the basket filter.
5. Clean and descale the basket filter.

If the basket filter is soiled so heavily that it cannot be cleaned, the basket filter must be replaced.

6. Insert the cleaned or a new basket filter.
7. Screw on the reinforced braided hose.

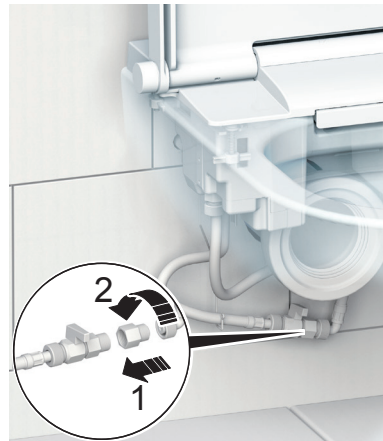

8. Open the ball valve underneath the toilet ceramic appliance.

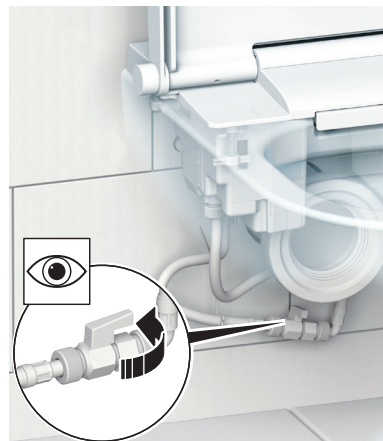

# MALFUNCTIONS DURING OPERATION



## ELECTRICAL SHOCK ! FATAL DANGER !

Never open the unit in order to repair it yourself. Never modify the device or add any additional modules. The AXENT shower toilet carries live parts and opening it exposes those present to fatal danger ! Warranty and liability claims as a result of wrong handling are specifically excluded.

Malfunction	Cause	Fault clearance
No Function	The unit is in stand-by-mode	Slightly knock the toilet lid
	Main plug is not connected	Connect the main plug
	Defective fuse on electrical distributor	Replace fuse on electrical distributor
	Fuse in internal mains connection is defective	Disconnect the main plug and contact customer service
	Power supply is interrupted	Have the power supply checked by a skilled person
No water spray (5 times «beep»)	No water supply	Ensure the water supply is released
Shower temperature too low	Shower temperature is set too low	Increase shower temperature
Shower spray is too weak or no water is spraying out at all	Spray intensity is set too low	Increase spray intensity
	Spray nozzle clogged or blocked with lime-scale	Run decalcification program
	Basket filter is clogged or blocked with lime-scale	Clean or replace the basket filter Contact customer service for floor-standing model
Spray arm does not move out	Power supply is interrupted	Restore the power supply
	No water supply	Ensure that the water supply is released
Night light doesn't work	Night light is in OFF mode	Switch night light into ON or AUTO mode
Night light cannot turn off	Night light is in ON mode	Switch night light into AUTO or OFF mode
Continuous «beep»	Shower toilet is defective	Disconnect the main plug and contact customer service

# MALFUNCTIONS DURING OPERATION



## ELECTRICAL SHOCK ! FATAL DANGER !

Never open the unit in order to repair it yourself. Never modify the device or add an any additional modules. The AXENT shower toilet carries live parts and opening it exposes those present to fatal danger ! Warranty and liability claims as a result of wrong handling are specifically excluded.

## AXENT.ONE<sup>PLUS</sup>

Additional malfunctions during operation for AXENT.ONE<sup>Plus</sup> products only.

Malfunction	Cause	Fault clearance
Remote control doesn't work	The storage battery is empty	Recharge the storage battery
Deodorizer does not work	Shower toilet is defective	Contact customer service
The dryer temperature is too low	The temperature setting is on lowest level.	Set a higher temperature level
Dryer does not work	Shower toilet is defective	Contact customer service
The seat heating temperature is too low	The temperature setting is on lowest level.	Set a higher temperature level
Seat heating does not work	Shower toilet is defective	Shower toilet is defective

# GUARANTEE / ENVIRONMENT

## GUARANTEE

---

Guarantee for production and material is 2 years from the installation of the product.

Claims can only be made under this guarantee if

- The installation and set-up has been done by an authorised installation company.
- The device has been used and maintained as advised in the user manual.
- There has been no external damage to the device during set up, installation, maintenance and cleaning.
- There have been no modifications on the AXENT shower toilet.
- Guarantee only takes place in countries AXENT has its place of business or has a legal subcontractor of AXENT.

Should a product or material fault occur within the guarantee period, AXENT will arrange following:

AXENT will arrange for necessary maintenance work to be carried out by an appointed customer service to replace faulty parts free of charge. Within this guarantee a cancellation of sale cannot be claimed by the end customer.

Once the guarantee has expired, AXENT will not honour any claims by the end customer that are based on this guarantee. This includes claims also relating to parts of the product that have been changed or repaired during the guarantee period. This guarantee is exclusively subject to the Swiss law. Expressly excluded are the United Nations Convention on Contracts for the International Sales of Goods. Any dispute arising from this guarantee, fall within the jurisdiction of the court at the place of business of AXENT.

## SUBSTANCE OF CONTENT

---

The AXENT shower toilet meets the requirements of the EU directive « Restriction of Hazardous Substances » (2011 / 65 / EU, RoHS). It is largely free of hazardous substances such as lead, cadmium, mercury or chrome VI.

The European chemical regulation REACH (1907/2006/EG), which regulates the registration, assessment, approval and restriction of certain chemical substances, is also complied with.

## PROPER HANDLING WASTE MANAGEMENT

---

In accordance with Directive 2012/19/EU (WEEE-II), manufacturers of electrical equipment are obliged to take back old equipment and to dispose of it appropriately.

Electronic devices often contain still usable materials. At the same time but also many harmful substances that ensure the operation and safety of the equipment. Mishandling or improper disposal of these substances are harmful to humans and the environment.



This symbol on the nameplate of your device refers to the prohibition of disposal with the usual household waste.

Please contact your local recycling facility to return waste electrical equipment and ensure its recovery. There is also the possibility to contact AXENT for proper disposal which is free of charge. In the meantime store the device in a child safe area. With the marking of plastic parts according to international standards for separation, the plastic is disposed appropriately. As for this, your old device will be recycled environmentally conscious.

Please note! Batteries are not allowed to be disposed in household waste.

## DECLARATION OF CONFORMITY

---

You can obtain a copy of the declaration of conformity from your responsible AXENT sales company.

# TECHNICAL DATA

	AXENT.ONE	AXENT.ONE <sup>PLUS</sup>
Article No	E80.0500.0001.9  E80.0600.0001.9	E80.0510.0001.9 / E80.0510.0101.9 E80.0510.0201.9 E81.0510.0001.9 / E81.0510.0101.9 E81.0510.0201.9 E80.0610.0001.9 / E80.0610.0101.9 E80.0610.0201.9 E81.0610.0001.9 / E81.0610.0101.9 E81.0610.0201.9
Nominal voltage	230V AC/ 50Hz	230V AC/ 50Hz
Power consumption (max.)	1600 W	1600 W
Nominal power consumption	1420 W	1420 W
Power consumption Eco modus	0.5 W	0.5 W
Protection degree	IPX4	IPX4
Protection class	I	I
Flow pressure range	0.07 – 0.75 MPa	0.07 – 0.75 MPa
Adaptable temperature range	4 – 40 °C	4 – 40 °C
Adaptable water temperature range	4 – 35 °C	4 – 35 °C
Load seat and lid (max.)	150 kg	150 kg
Min. flow rate Rear-shower	350 ml/min	350 ml/min 5 levels
Min. flow rate Lady-shower	350 ml/min	350 ml/min 5 levels
Max. shower time per use	3 min	3 min
Spray arm position	5 levels	5 levels
Water temperature	31 to 39 °C /OFF	31 to 39 °C /OFF / 5 levels
Dryer temperature		30 to 50 °C /OFF / 5 levels
Seat temperature		29 to 37 °C /OFF / 5 levels
Bluetooth: frequency range	2402 MHz – 2480 MHz	2402 MHz – 2480 MHz
Bluetooth: maximum output power	4.5 dBm	4.5 dBm
Radio frequency: frequency	2433 MHz	2433 MHz
Radio frequency: maximum output power	3.5 dBm	3.5 dBm

Subject to change



Depending on the actual conditions, the measured values of the water, air dryer and seat temperature may differ slightly from the specified temperatures.



**AXENT International AG**

[info@axent-bclean.com](mailto:info@axent-bclean.com)  
[www.axent-bclean.com](http://www.axent-bclean.com)