

AXENT
SWITZERLAND

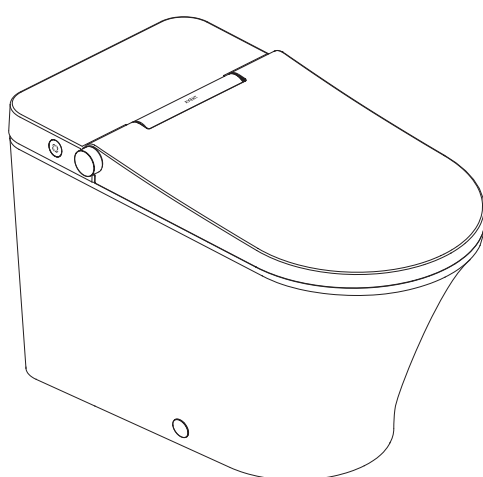

AXENT.ONE C

INSTALLATION INSTRUCTIONS

Thank you for placing your confidence in us.

Thank you for buying AXENT products. You can learn from this manual about installation steps before initial start-up.

Please follow the instructions in this manual carefully.
Please keep the manual properly stored for future reference.
Regarding future product updates, the product is subject to change without prior notice.

Illustrations in this manual serve as visual demonstration.

We hope you can learn how to install the product through this manual.

In order to guarantee that the Product will always function optimally, and to ensure your personal safety, please do the following:





Read these operating instructions carefully before initial start-up and follow these instructions!







INSTALL PREPARATIONS

- 1.Please read theses instructions carefully before installation.
- 2.Installation should be based on the steps documented in this manual. AXENT will not take responsibility for the negative consequences caused by the changed construction method without authorization.
- 3.It shall be confirmed that the distance between the pit center and the wall matches with the product.
- 4.Do the waterproofing for the ground and wall before installation.
- 5.Since ceramics can be easily damaged it should be handled with care during installation, also do not tighten the nuts excessively to avoid damage to the product. The bottom part of the toilet shall not be fixed and installed using cement.
- 6.The power voltage is AC 220~240 V~, 50/60 Hz. Use the specified power supply only.
- 7.According to the length of the power supply cord documented in this manual, the electrical power supply should be located close to the installation position of this product.
- 8.Hydrostatic Pressure Range: 0.14~0.75Mpa; Water Temperature Range: 4~35℃
- 9.Do not remove the static film on the product during installation to avoid scratching the surface of the product.
- 10.After the installation, water shall be supplied before power up.
- 11.**Due to the water flow test in factory before delivery, a small amount of water may flow out when taking the product out, which is normal.**

Safety

- The following warning signs warn you of dangerous situations and their severity. In order to avoid harm to you and others, be sure to follow the list of items.

<div>DANGER! High risk, lethal hazards, severe injuries</div>	<div>CAUTION! Low risk, minor injuries, damage to property</div>
<div>PROHIBIT! Strictly avoided</div>	<div>MANDATORY Violation of the relevant regulations</div>

<div><div>DANGER!</div><div><ul style="list-style-type: none">● Sockets shall not be allowed too loose, and the power plug should be completely inserted to avoid electric shock or fire.● Please use the components attached to the product, otherwise it may cause water leakage, flood, electric shock.● The circuit construction should abide by the rules of indoor wiring, otherwise it may cause fire and electric shock.● Please do not install the product in the damp place, which may cause fire or electric shock.● Do not replace the power supply cord by yourself which may lead to fire and electric shock. If you need to replace the power supply cord, it must be replaced by the manufacturer, its service agent or similar qualified persons in order to avoid hazard.</div></div>	<div><div>DANGER!</div><div><ul style="list-style-type: none">● Do not use a bidet seat with a damaged cord which may cause electric shock, short circuit, fire.● Do not allow to place open flames, candles, cigarettes, or similar objects on or by the toilet.● Do not allow to use industrial water, circulating water or waste water as the source of the product. Please use the water source that meets the standard of living and drinking.</div></div>
	<div><div>CAUTION!</div><div><ul style="list-style-type: none">● Please comply with all local regulations on water supply and drainage, otherwise it may lead to a safety hazard.● Only use the new hose-sets supplied with the product.● When moving the product, please hold the main body. if only moving with the cover and the seat, the components maybe separated from the main body.</div></div>

APPLICABLE PRODUCTS

Model	Remote control	ceramics
E312-01	Remote control B	Straight type
E322-02	Remote control A	Arc type
E323-03	Remote control C	Arc type

DIMENSION(Unit:mm)

- [E312-01]

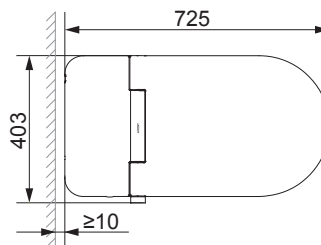
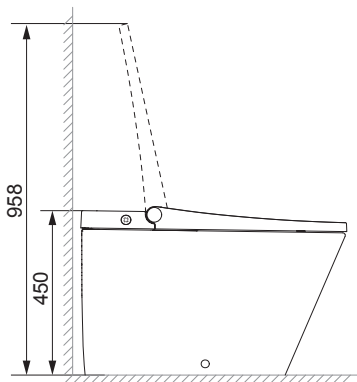

Please ensure that the distance from the wall and the product meets the requirements so that the repair work can be carried out normally.

- [E322-02]

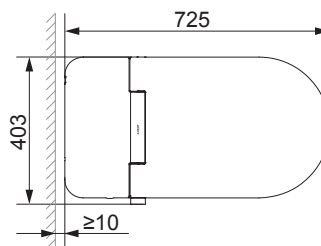
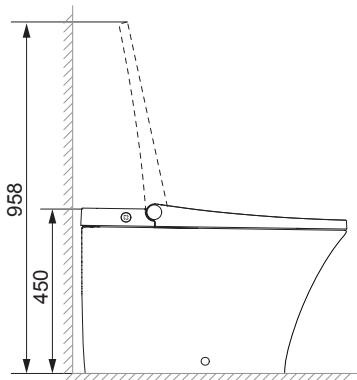

Please ensure that the distance from the wall and the product meets the requirements so that the repair work can be carried out normally.

- [E323-03]

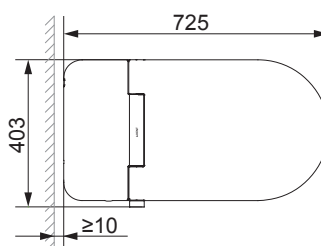
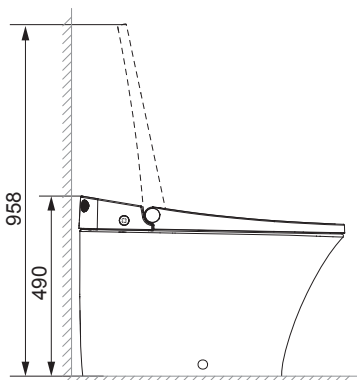

Please ensure that the distance from the wall and the product meets the requirements so that the repair work can be carried out normally.

This manual is illustrated by the diagram of [E322-02].
The different models are only different in appearance, and the installation method is the same.

PRE INSTALLATION CONFIRMATION

STANDARD DELIVERY CONTENTS

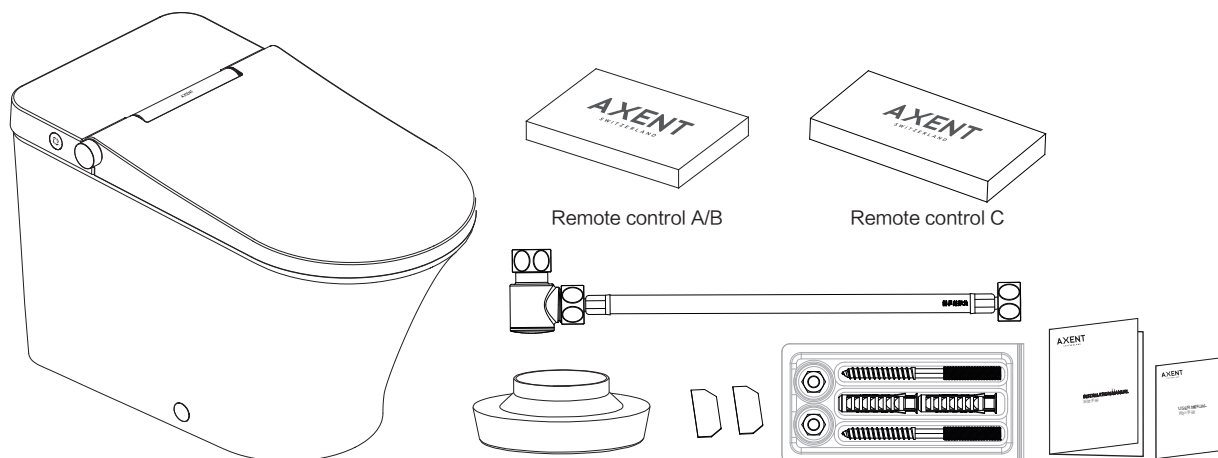

INSTALLATION TOOLS

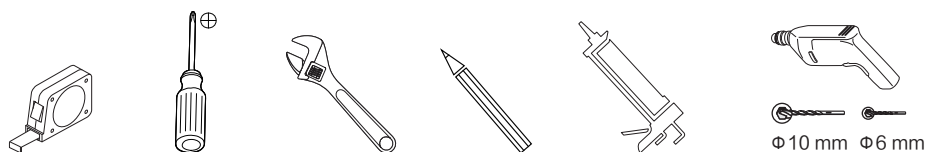

INSTALL PREPARATIONS

- 1.Ensure that the tiles and wall bricks have been laid, at the same time the pipes in pit and water supply pipes have been reserved before installation.
- 2.It shall be confirmed that the height of pipe 5-10 mm over the ground, and distance from its center to the wall (distance between the pit center and the wall) matches with the product.
- 3.Open the angle valve, and clear the impurities and sludge in the embedded pipe before installation to make sure the product is running normally.
- 4.Please refer to the size indicated in the figure below and reserve the installation position, to avoid affecting the normal use of the inlet pipe and power supply line.
- 5.The socket circuit connected to the product must have residual current protective device with a rated residual operating current not exceeding 30mA.

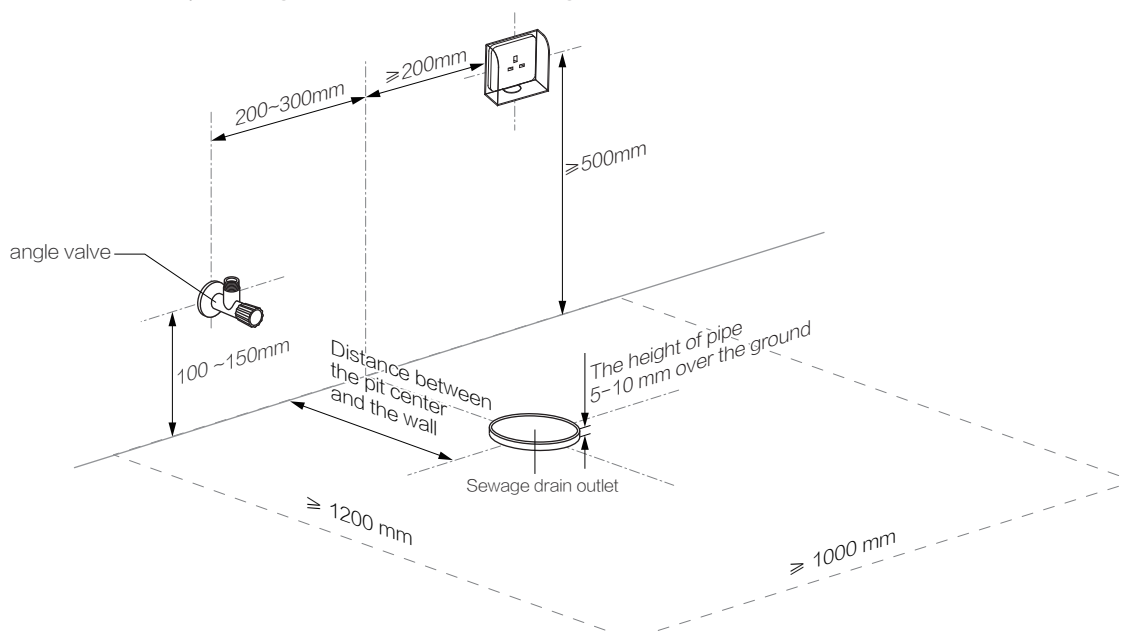

TOILET INSTALLATION

1

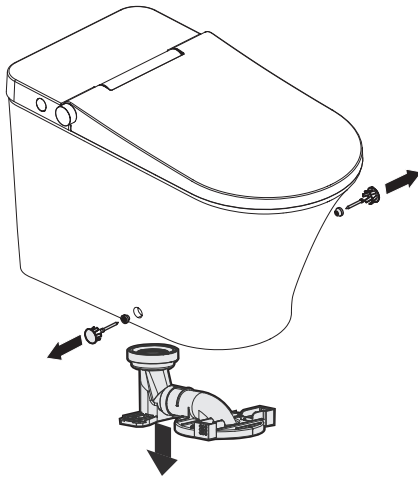

2

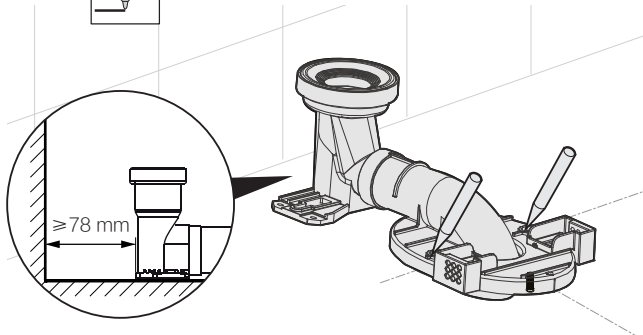

Please ensure that the distance from the wall and the product meets the requirements so that the repair work can be carried out normally.

3

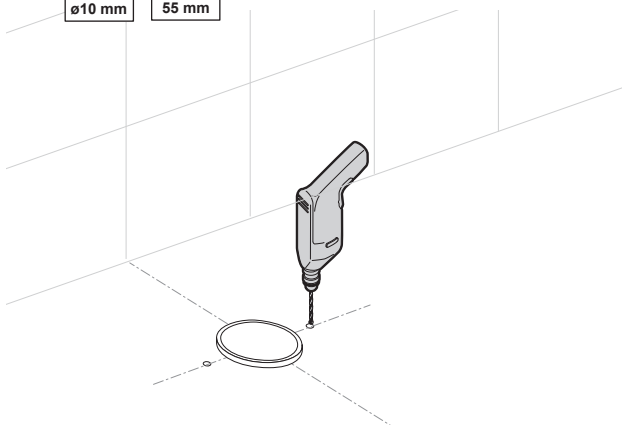

4

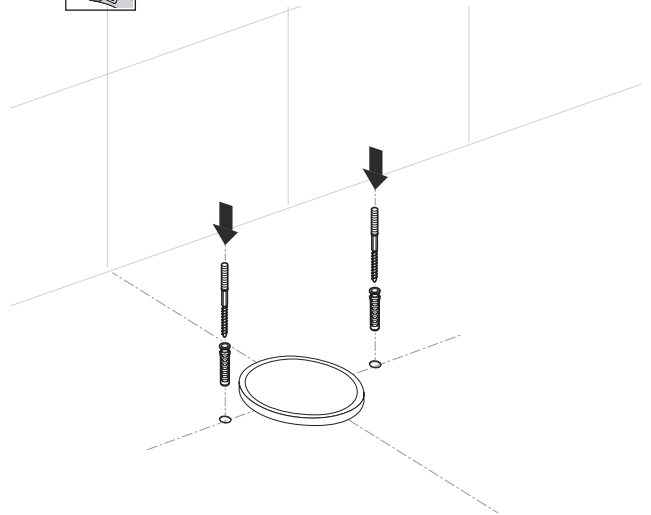

5

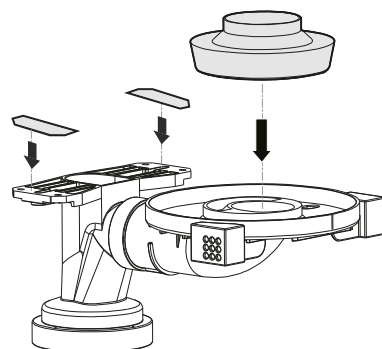

6

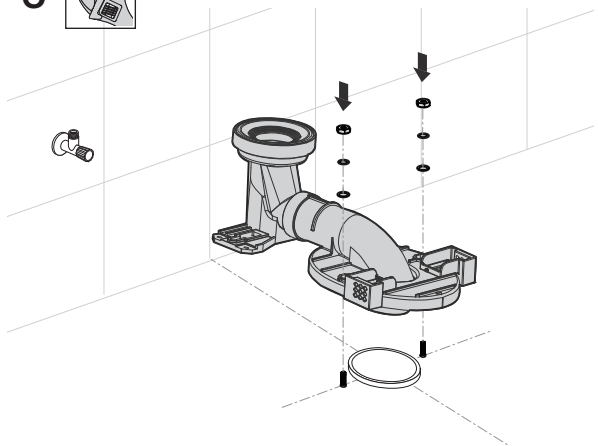

INSTALLATION STEPS

7 

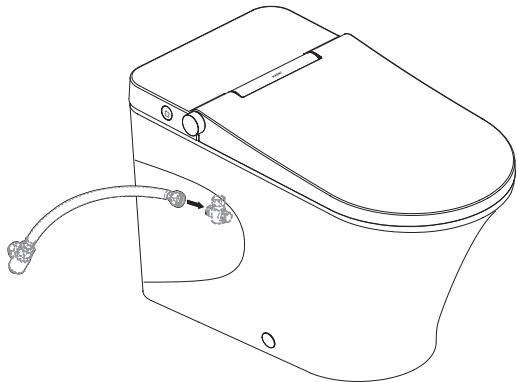

10 

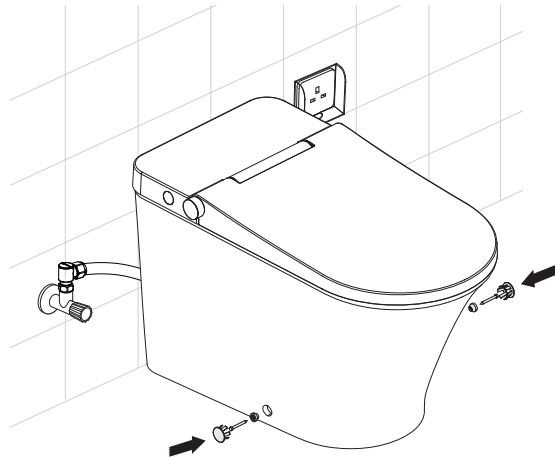

8

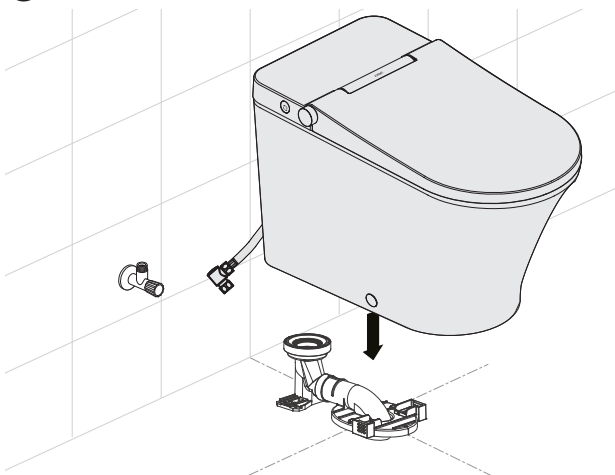

11

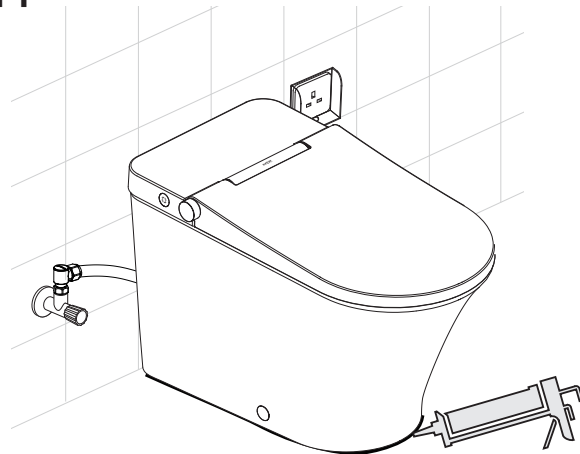

9 

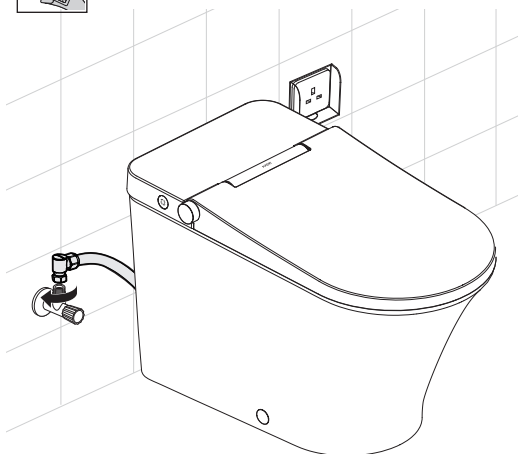

12

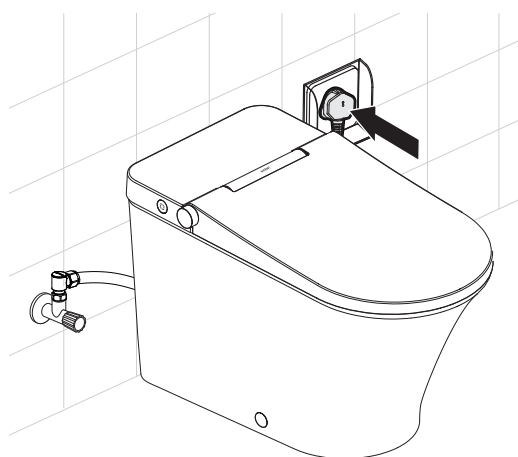

REMOTE CONTROL A/B INSTALLATION

1

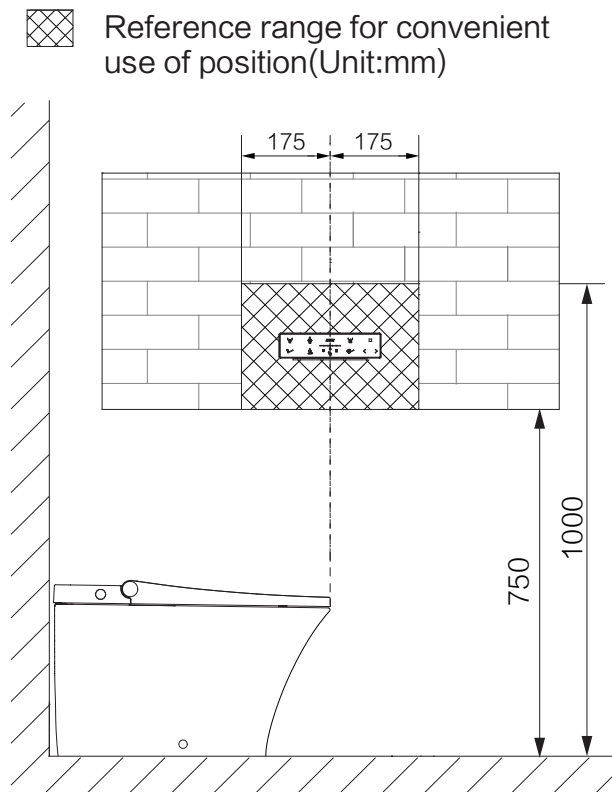

2

▼ Remote control A

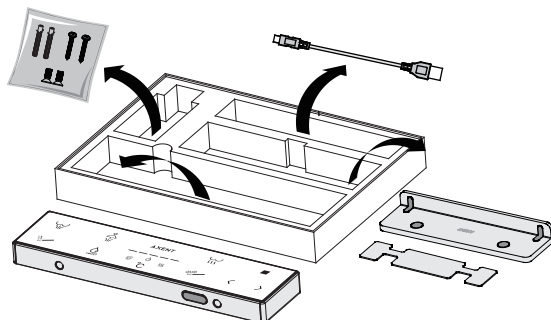

▼ Remote control B

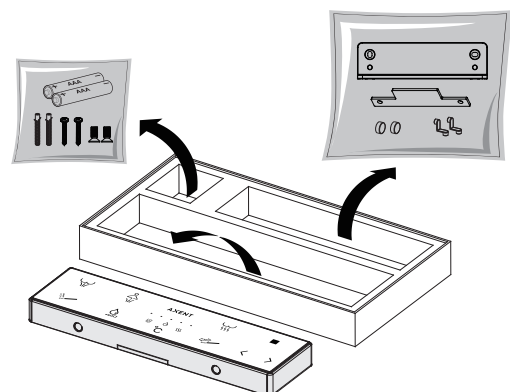

3 (Only remote control A)

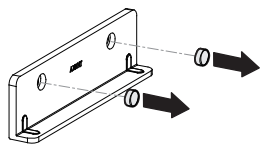

4

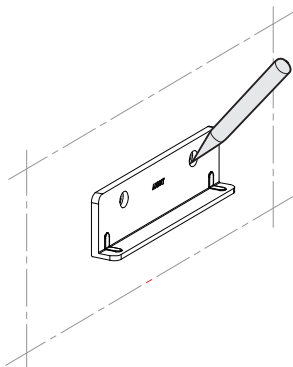

5

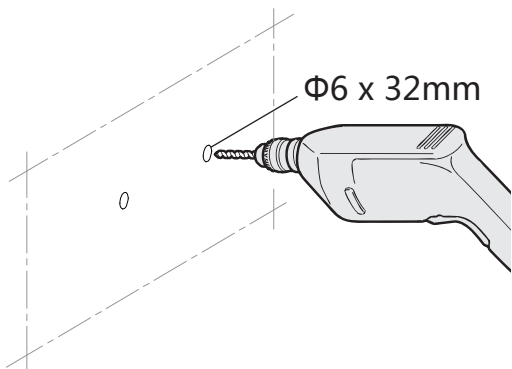

6

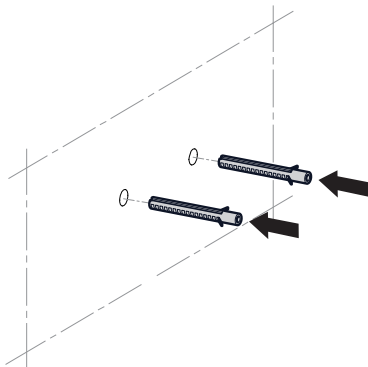

7 ▼ Remote control A

1

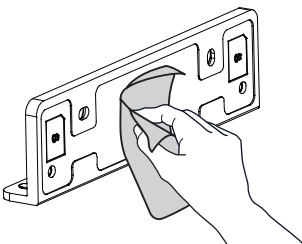

2

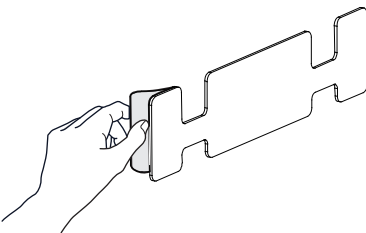

3

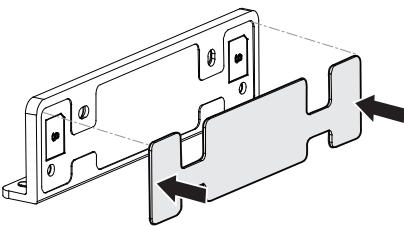

4

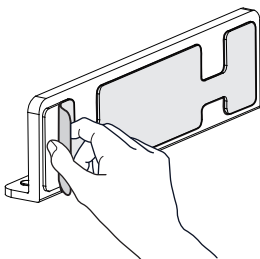

7 ▼ Remote control B

1

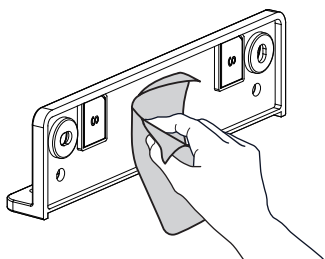

2

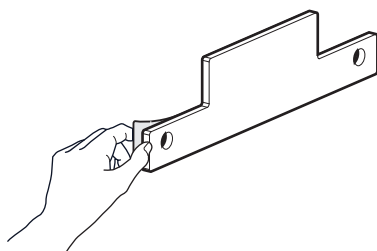

3

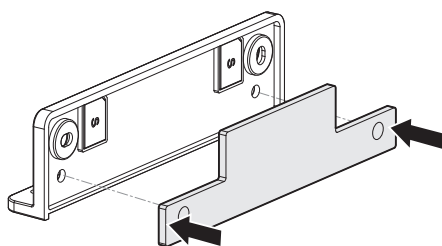

4

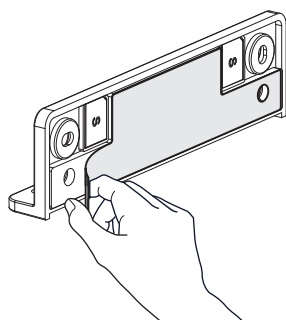

8

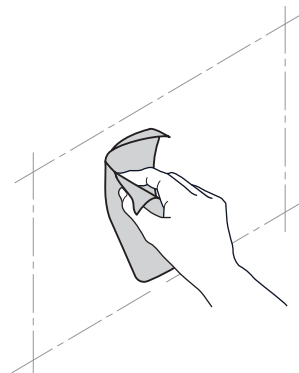

9

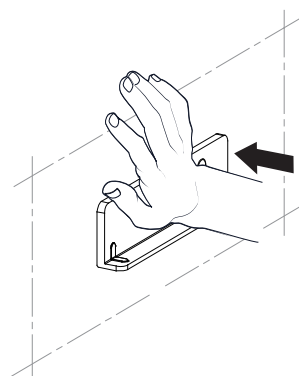

10

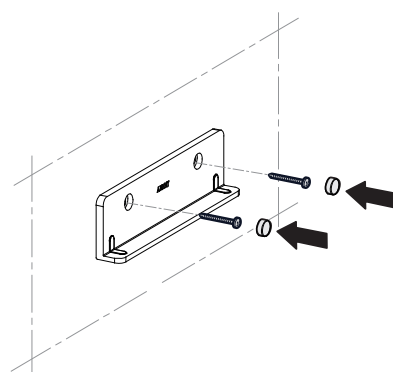

11

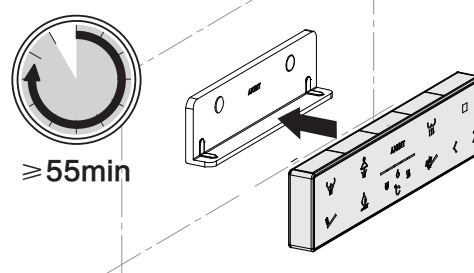

INSTALLATION STEPS

BATTERIES INSTALLATION
(Only remote control B)

1

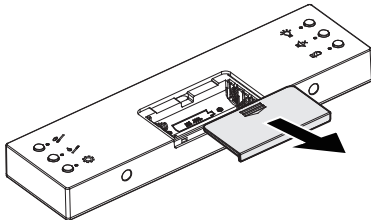

2

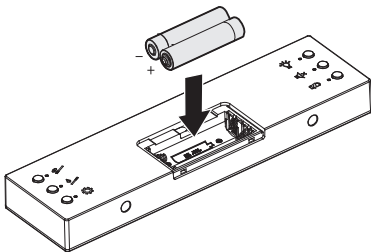

3

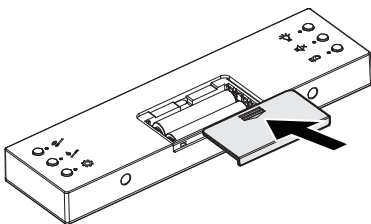

4

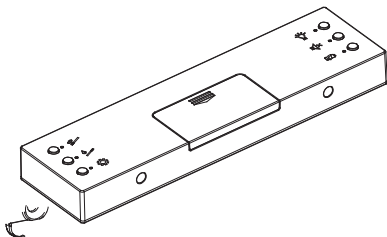

REMOTE CONTROL FIXED
(optional)

1

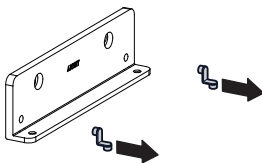

2

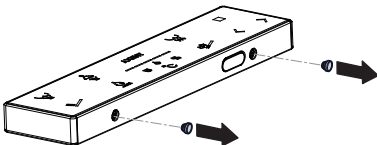

3

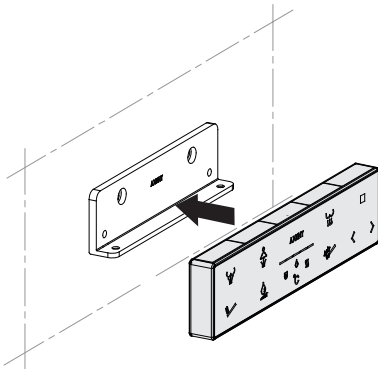

4

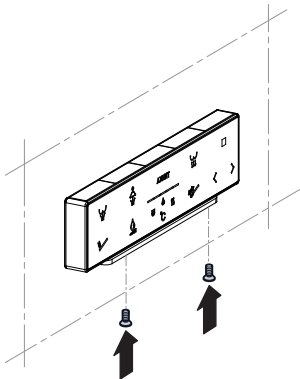

REMOTE CONTROL C INSTALLATION

1

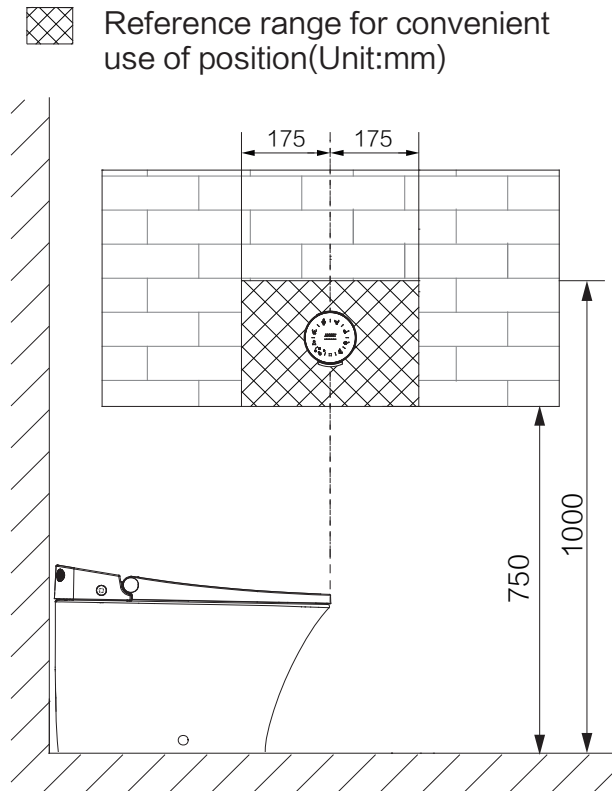

2

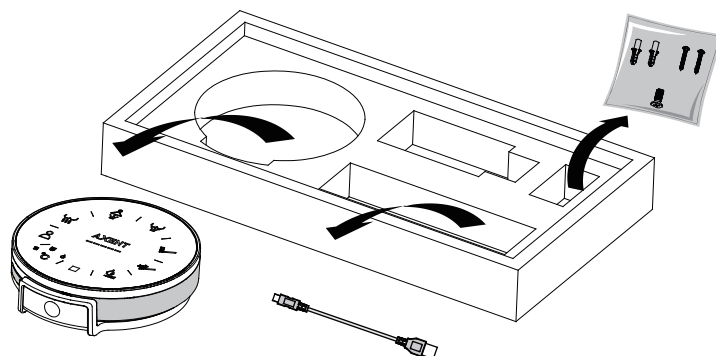

INSTALLATION STEPS

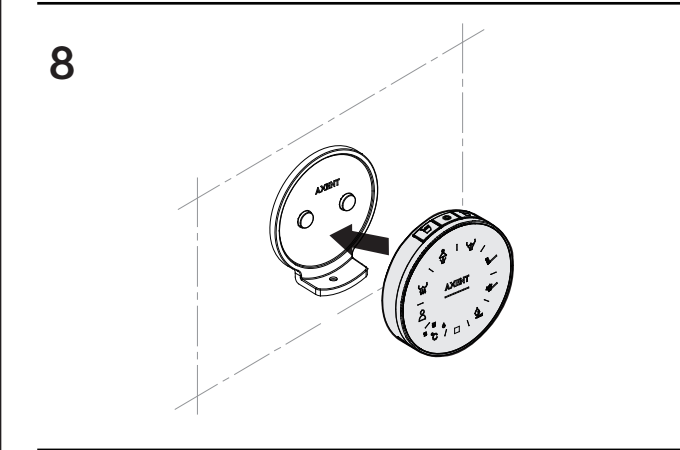
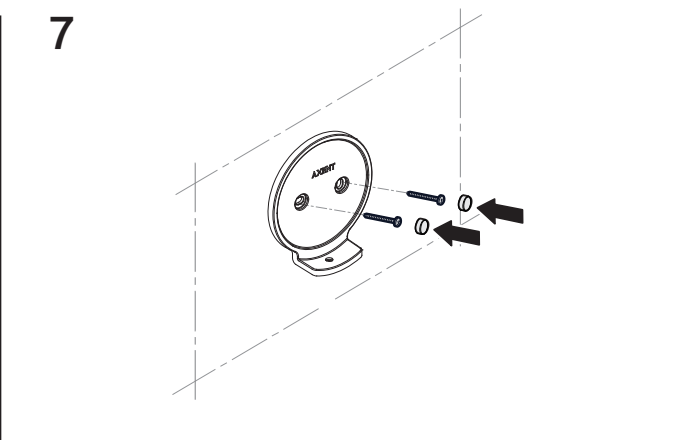
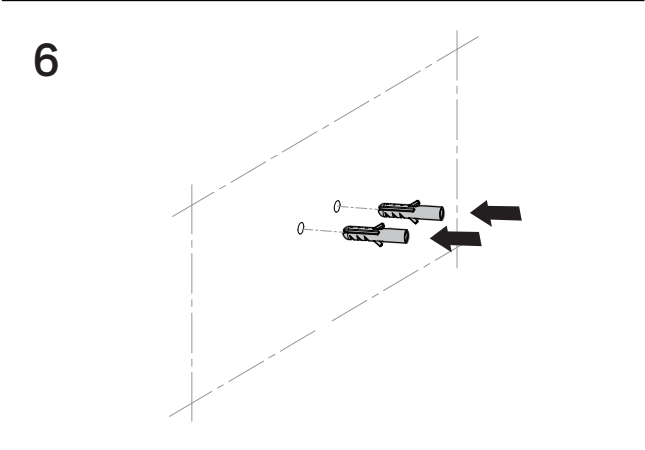
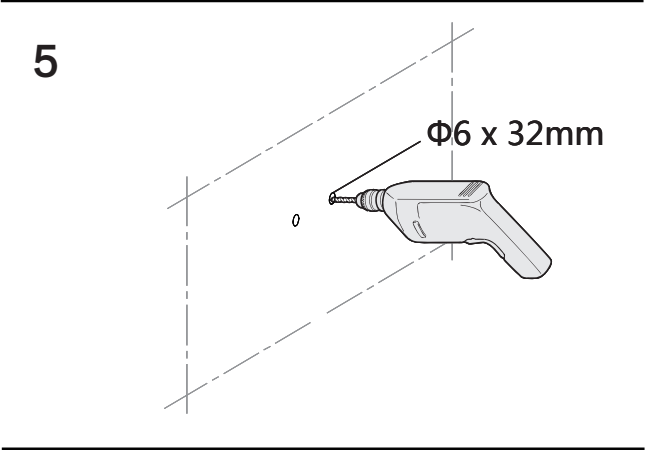
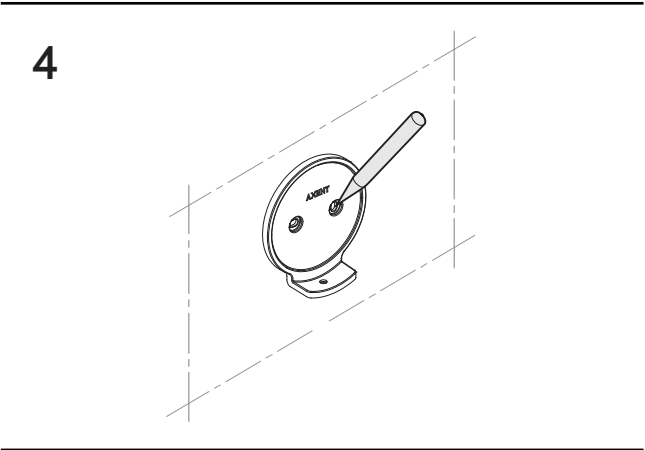
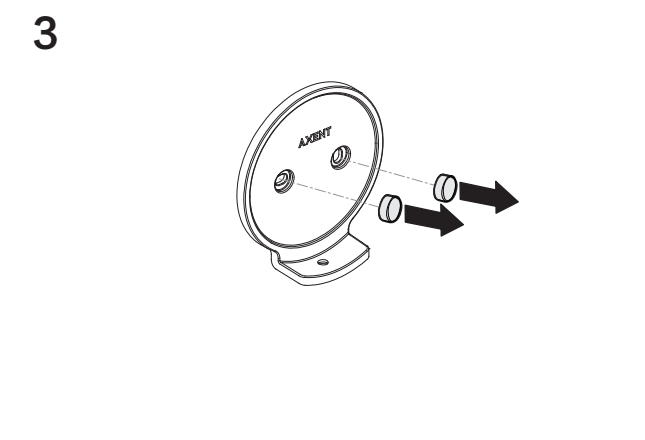

■ REMOTE CONTROL FIXED (OPTIONAL)

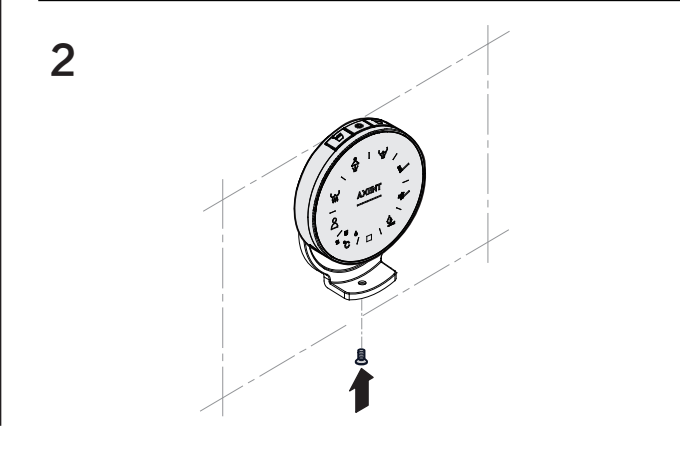
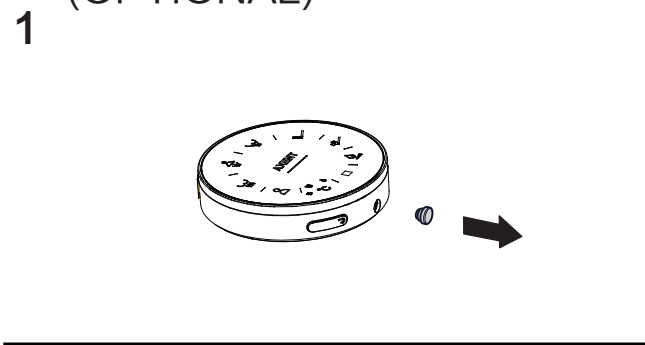

■ TEST

1) WATER SUPPLY

Turn on the angle valve.

2)POWER ON

Insert the power plug into the socket, and confirm that pushing the plug firmly in place.



CAUTION!

- This device is an electric appliance of class I and must be connected to a grounding system.
- Do not allow the power cord to be severely pinched or kinked to avoid affecting normal use.

3)FUNCTIONAL TEST

Touch the sensing area by hand to test the flushing and cleaning functions, and check the leakage. Make sure the product and remote control are running normally.



NOTE!

- Please cover the spray arm during testing to avoid sprayed.
- Do not bend the pipe at large angle, to avoid affecting the service life of the water pipe.

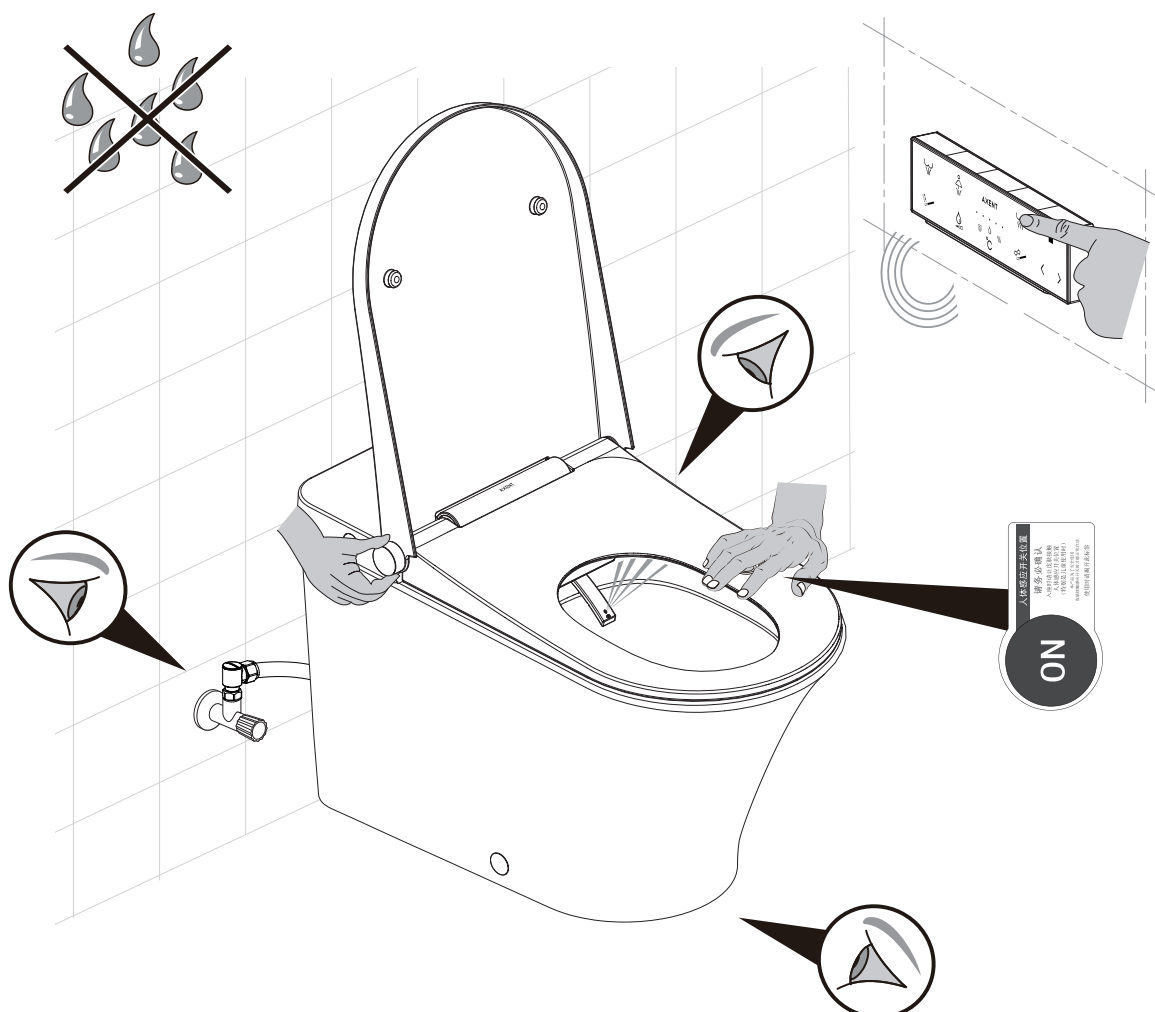

AXENT(Shanghai) Corporation Ltd.

Add: A, C, D Rooms, 10F, No. 9 Zhenning Road,
Changning District, Shanghai, China

Tel: +86 21 5238 7080

E-mail: service@axentbath.com www.axentbath.com